

June 20, 2017

Via Certified Mail, Return Receipt Requested

Oklahoma Corporation Commission
Attn: Director of Public Utility Division
P.O. Box 52000
Oklahoma City, OK 73152-2000

RE: Notification of Intent to Build a Wind Energy Facility in Texas County, Oklahoma and Cimarron County, Oklahoma.

Ladies and Gentlemen:

Pursuant to the Oklahoma Wind Energy Development Act (Act) and the Oklahoma Corporation Commission (OCC) rules implementing the Act, this letter is a notification of intent to build a wind energy facility. We intend to erect wind energy turbines and related facilities for the States Edge Wind Energy Project in Texas County, Oklahoma and Cimarron County, Oklahoma (Project). Notice is being provided within six (6) months of the initial filing of a Notice of Construction (Form 7460-1) with the Federal Aviation Administration (FAA), made on June 5, 2017. As of the date of this notice, and based on publicly available data, we confirm that the Project design complies with the setbacks required by the Act.

This phase of the Project will consist of 13 wind energy turbine generators and associated facilities. A map indicating the Project boundary and current proposed wind turbine locations is included with this letter as Exhibit A. A summary of the Federal Aviation Administration (FAA) information, including the coordinates and elevation of each turbine and key turbine dimensions are included with this letter as Exhibit B.

Simultaneously with sending you this notice, we are providing similar notice to the Texas County, Oklahoma Board of County Commissioners and Cimarron County, Oklahoma Board of County Commissioners. No project facilities are located within an incorporated area of a municipality.

Please file stamp a copy of this letter confirming your receipt and send us a file-stamped copy. Thank you.

Sincerely,
States Edge Wind Energy LLC

By: 
Name: Kelly Meyer
Title: Vice President

Exhibit A

Project Map and Turbine Locations

9

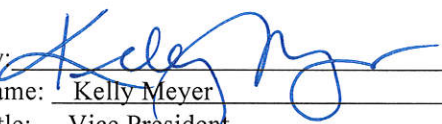
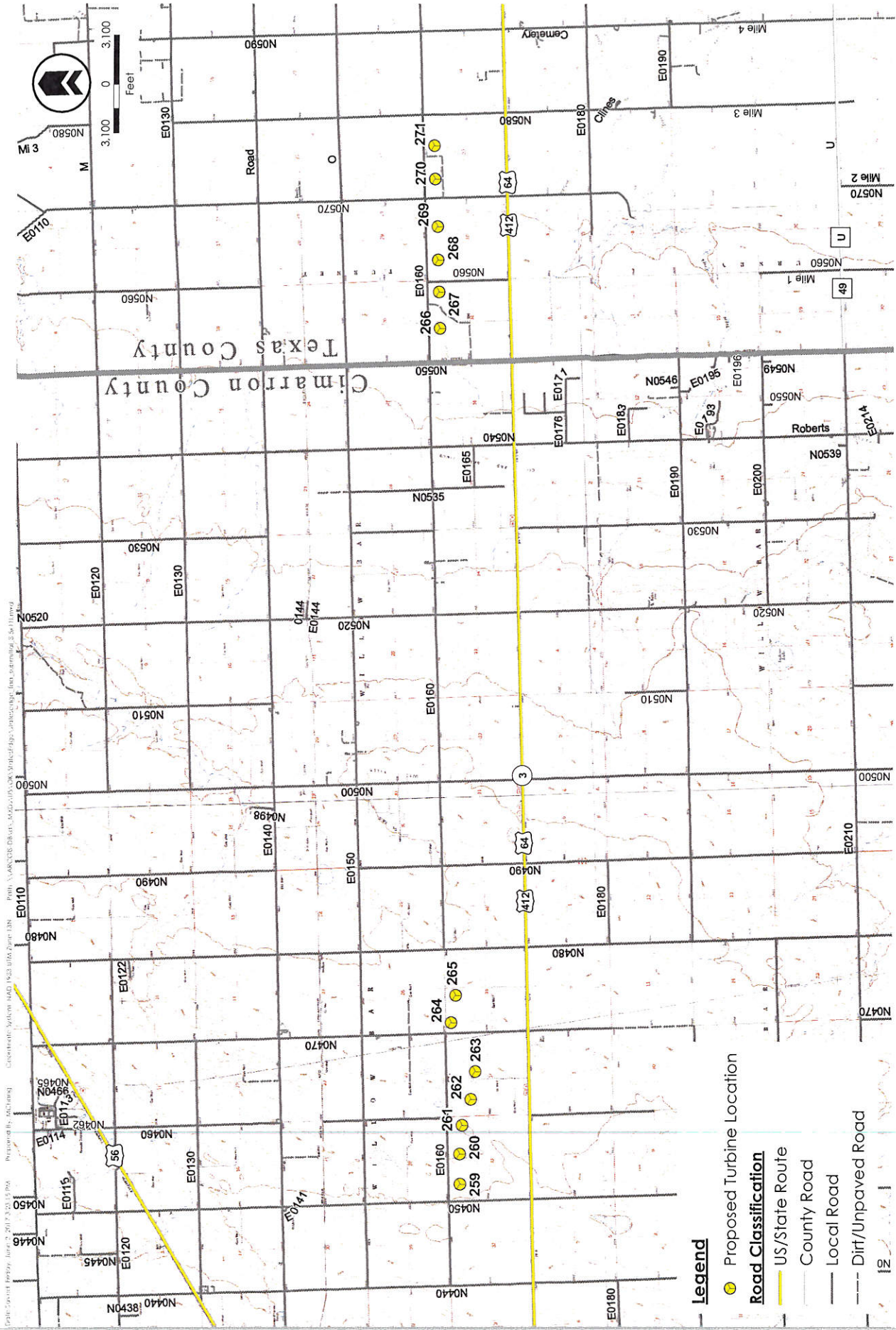

- Legend**
- Proposed Turbine Location
 - Road Classification**
 - US/State Route
 - County Road
 - Local Road
 - Dirt/Unpaved Road

Turbine Layout

States Edge Wind Energy Project | Cimarron and Texas Counties, Oklahoma

Rev. 00
June 05, 2017



Exhibit B

FAA Information

ASN	Structure Name	Latitude	Longitude	Ground Elevation (ft)	Structure Height (ft AGL)
2017-WTW-6508-OE	259	36° 46' 31.0626" N	102° 12' 30.3729" W	3897	499
2017-WTW-6509-OE	260	36° 46' 30.7698" N	102° 12' 07.1864" W	3896	499
2017-WTW-6510-OE	261	36° 46' 28.7101" N	102° 11' 45.1131" W	3887	499
2017-WTW-6511-OE	262	36° 46' 22.8954" N	102° 11' 25.2475" W	3882	499
2017-WTW-6512-OE	263	36° 46' 19.4879" N	102° 11' 03.6669" W	3873	499
2017-WTW-6513-OE	264	36° 46' 34.1644" N	102° 10' 25.5205" W	3862	499
2017-WTW-6514-OE	265	36° 46' 30.6543" N	102° 10' 04.3405" W	3857	499
2017-WTW-6515-OE	266	36° 46' 29.5861" N	102° 01' 27.9989" W	3682	499
2017-WTW-6516-OE	267	36° 46' 29.6178" N	102° 00' 59.9082" W	3677	499
2017-WTW-6517-OE	268	36° 46' 29.6175" N	102° 00' 34.7228" W	3667	499
2017-WTW-6518-OE	269	36° 46' 29.3806" N	102° 00' 09.0171" W	3657	499
2017-WTW-6519-OE	270	36° 46' 29.9676" N	101° 59' 31.9114" W	3645	499
2017-WTW-6520-OE	271	36° 46' 30.0365" N	101° 59' 06.1995" W	3634	499