



INTUNE SETUP



FOLLOW THESE STEPS TO SET UP INTUNE ON YOUR IPHONE

SETTINGS

TO BEGIN THE PROCESS, GO TO SETTINGS.

STEP 01

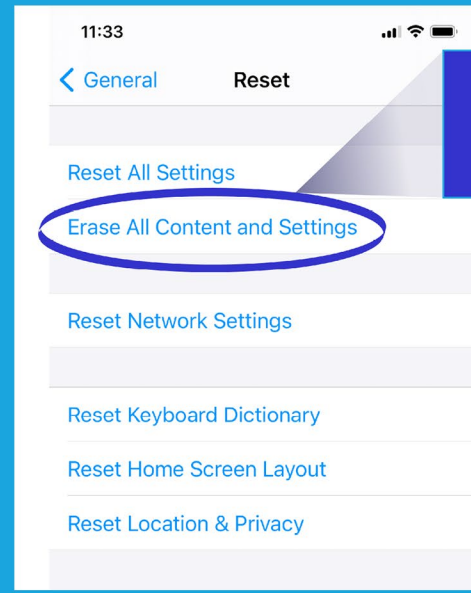

Select "Erase All Content and Settings"

ERASE

SELECT 'ERASE ALL CONTENT AND SETTINGS'. ENTER YOUR PASSCODE, SELECT 'ERASE IPHONE', THEN SELECT 'ERASE ALL & KEEP CELLULAR PLANS'.

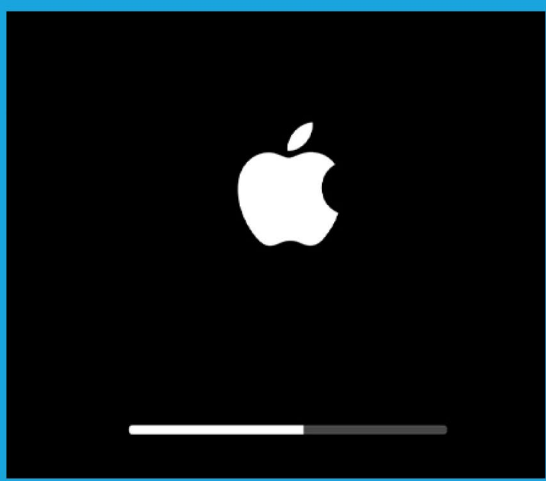

STEP 02

RESET

THE IPHONE WILL RESET AND YOU CAN BEGIN THE INTUNE SETUP.

STEP 03

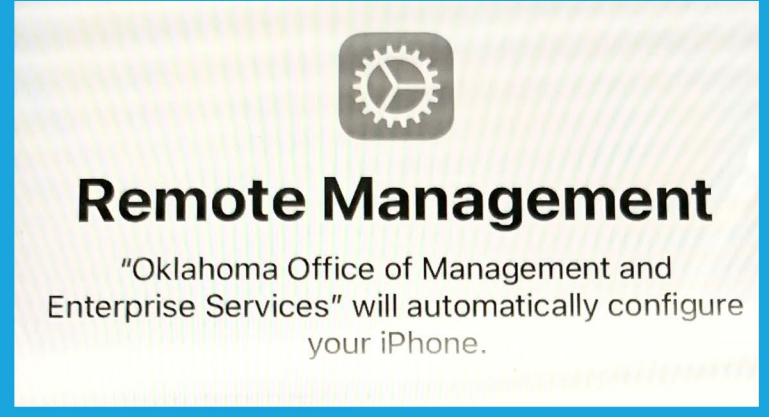

REMOTE MANAGEMENT

REMOTE MANAGEMENT WILL TAKE OVER TO CONFIGURE THE IPHONE.

SIGN IN

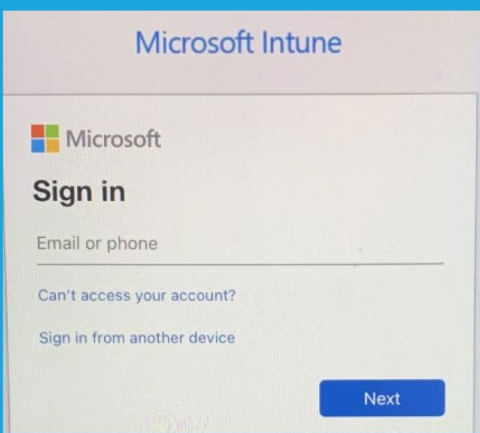

STEP 04

ENTER YOUR EMAIL ADDRESS AND YOU WILL BE REDIRECTED TO THE STATE OF OKLAHOMA PORTAL WHERE YOU WILL ENTER YOUR CREDENTIALS.

STEP 05



OKLAHOMA
Office of Management & Enterprise Services



INTUNE SETUP



FOLLOW THESE STEPS TO SET UP INTUNE ON YOUR IPHONE

LOADING...

WAIT FOR COMPANY RESOURCES TO LOAD.

STEP 06

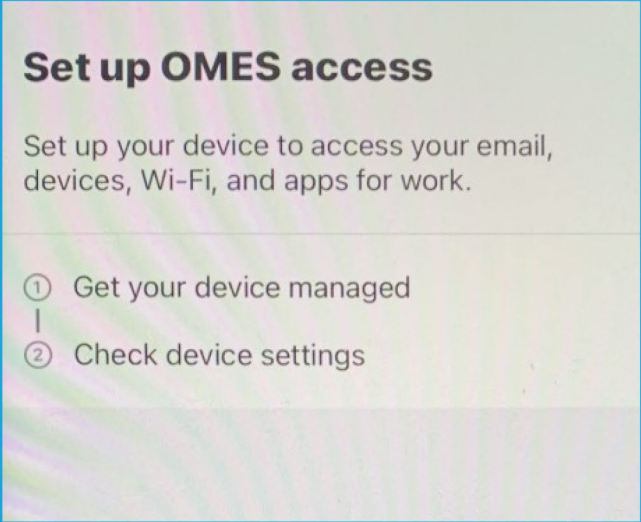

OMES ACCESS

SET UP OMES ACCESS AND NOTIFICATIONS.

STEP 07

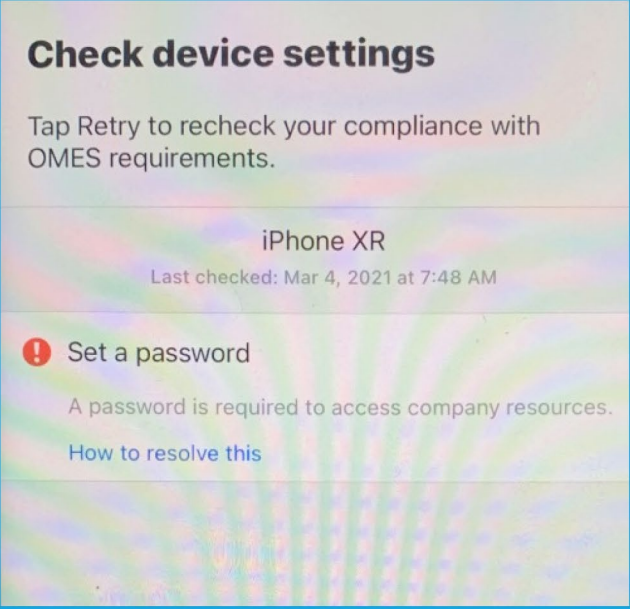

NEW PASSCODE

CHECK DEVICE SETTINGS AND SET UP A NEW PASSCODE.

STEP 08

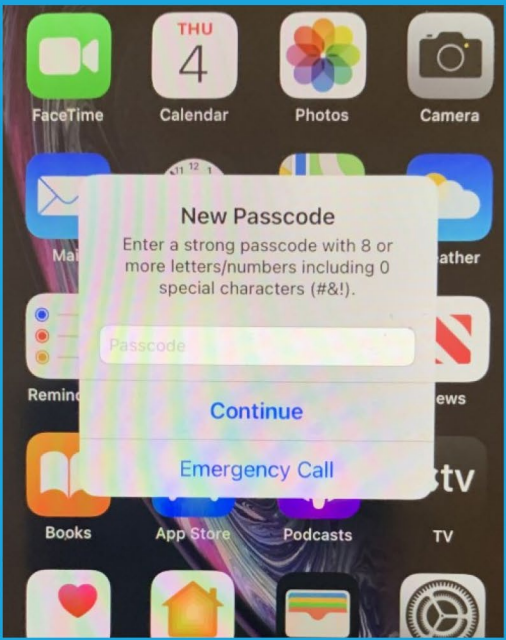

END

AFTER ENTERING A NEW PASSCODE, THE SETUP IS COMPLETE.

STEP 09

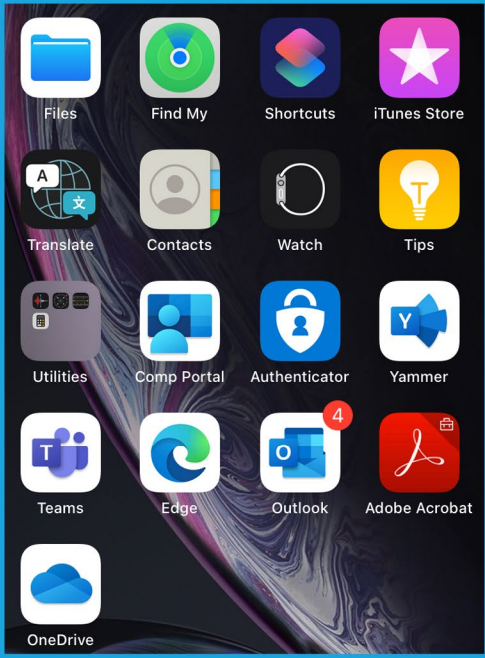

HELP

IF YOU NEED ADDITIONAL HELP, CONTACT SERVICEDESK@OMES.OK.GOV.



OKLAHOMA
Office of Management & Enterprise Services