

Swipe up to open.

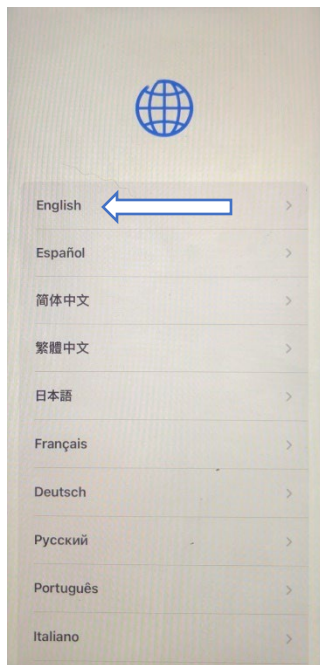

Select **English**.

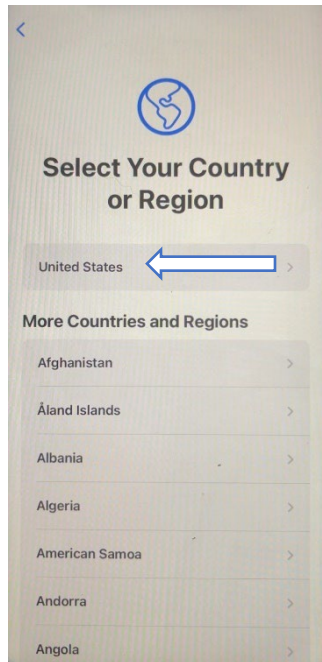

Select **United States.**

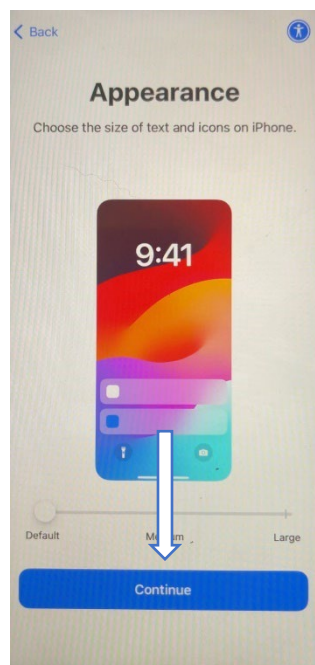

Select **Continue.**

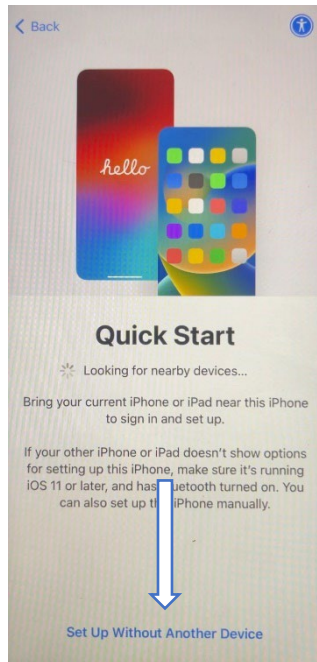

Select **Set Up Without Another Device.**

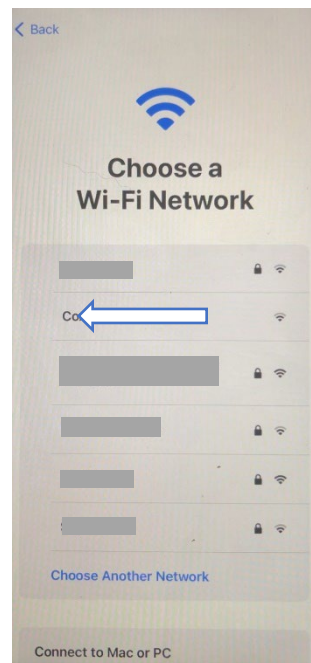

Choose a Wi-Fi Network. Use Oklahoma_Open if it is available. If you do not have access to Oklahoma_Open, you can use a personal Wi-Fi-Network, or continue without using Wi-Fi.

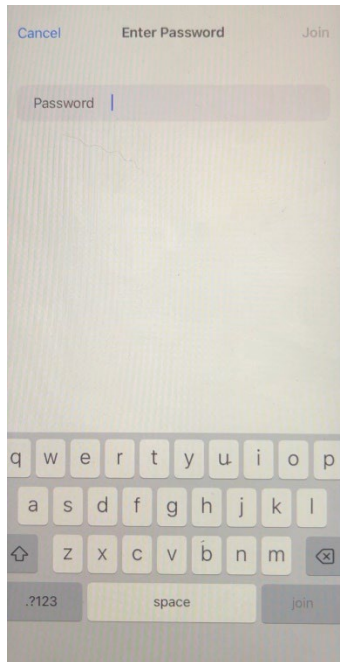

Enter in Wi-Fi password is needed.

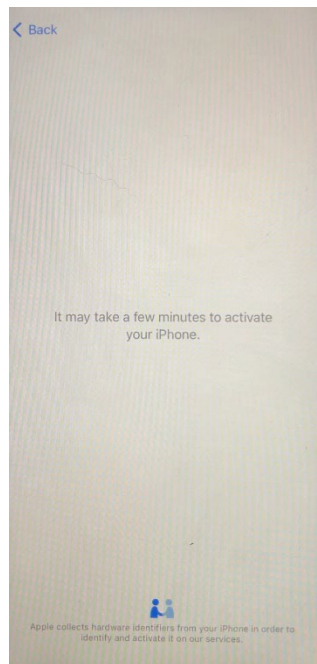

The phone is now activating.

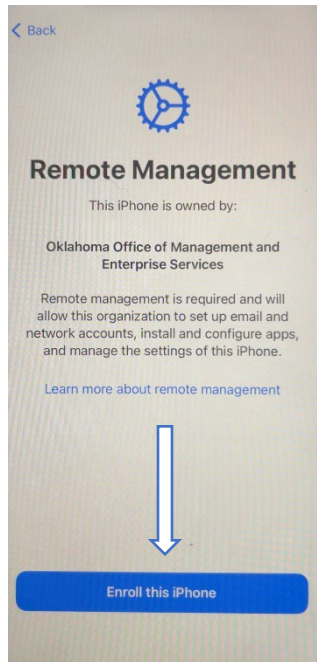

Select **Enroll this iPhone.**

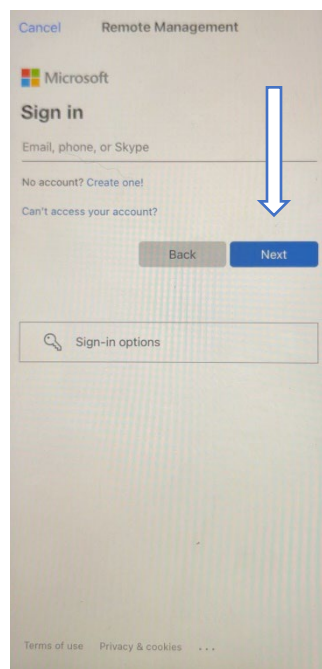

Enter in your Workday login information. Then select **Next.**

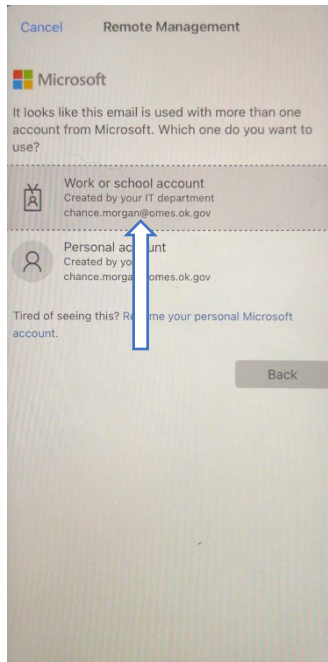

Select **Work or school account.**

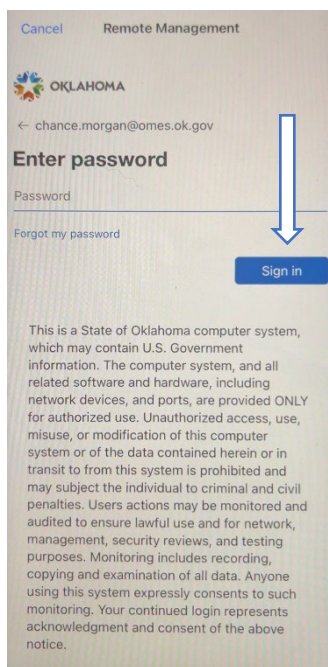

Enter in your Workday password, and then select **Sign in.**

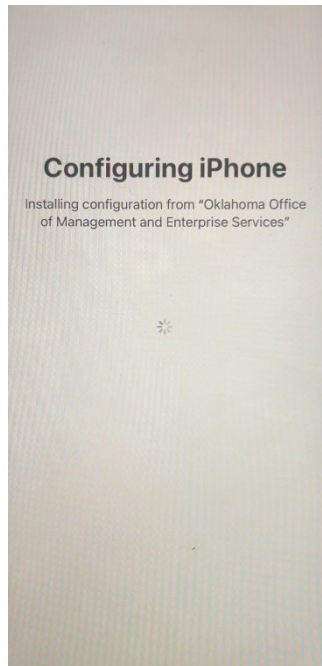

The iPhone is now configuring.

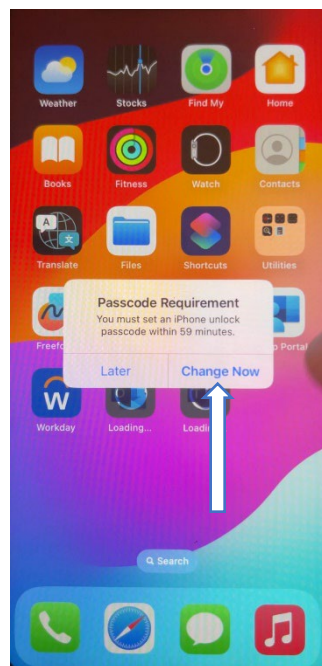

The device will open to the home screen. Wait a moment for the Passcode Requirement box to pop up. Select **Change Now**.

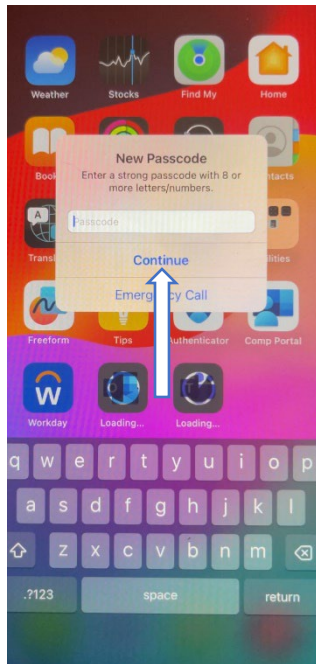

Enter in an 8-character alphanumeric passcode. Then select **Continue**.

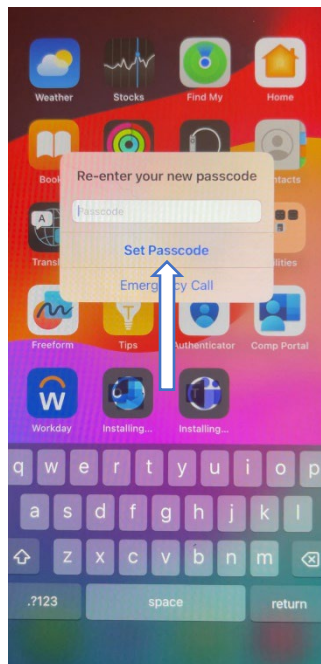

Re-enter your passcode and then select **Set Passcode**.

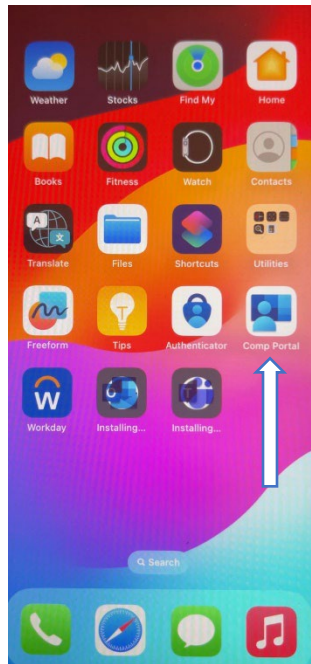

Select the Company Portal app.

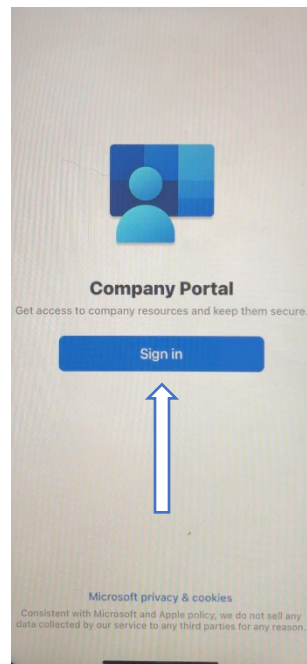

Select ***Sign in***.

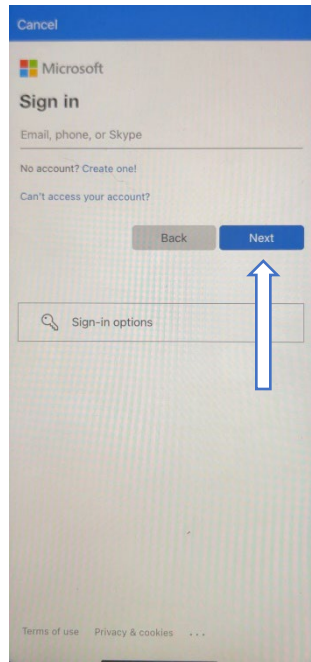

Enter in your Workday login information. Then select **Next**.

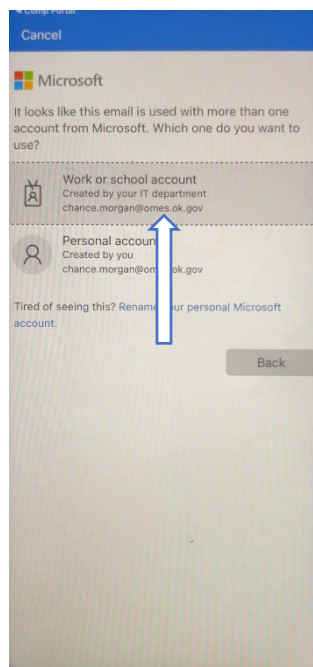

Select **Work or school account**.

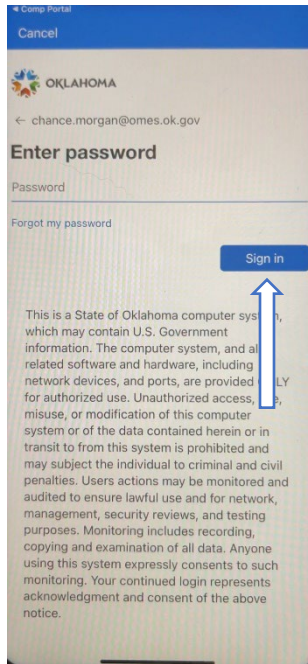

Enter in your Workday password, and then select **Sign in.**

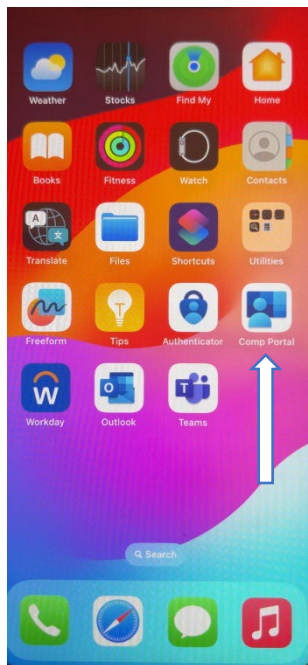

Select the Company Portal app.

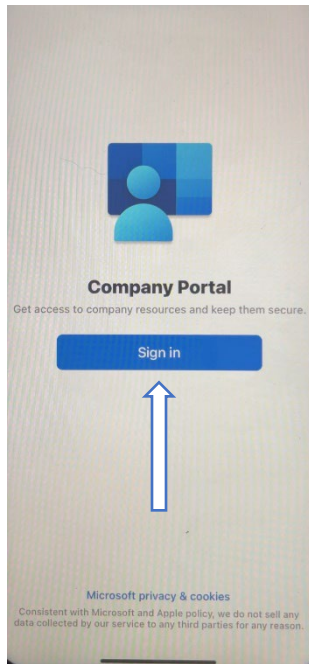

Select **Sign in.**

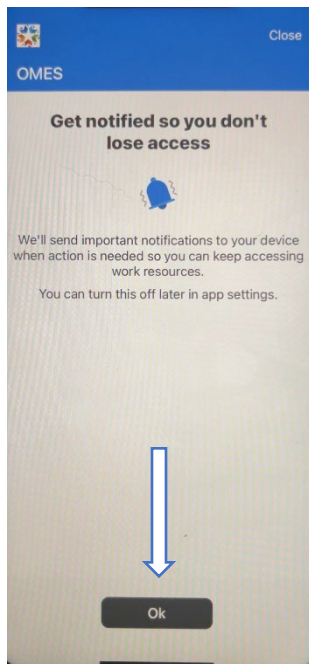

Select **Ok.**

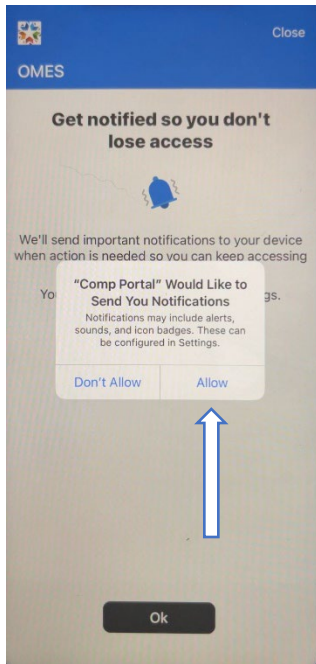

Select **Allow.**

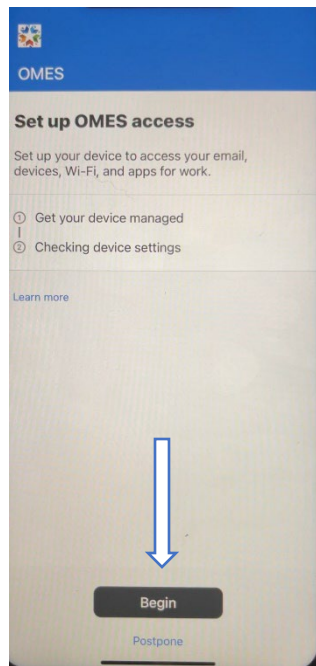

Select **Begin.**

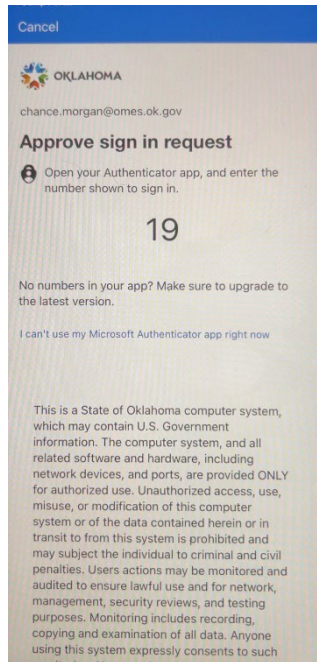

Authenticate the login.

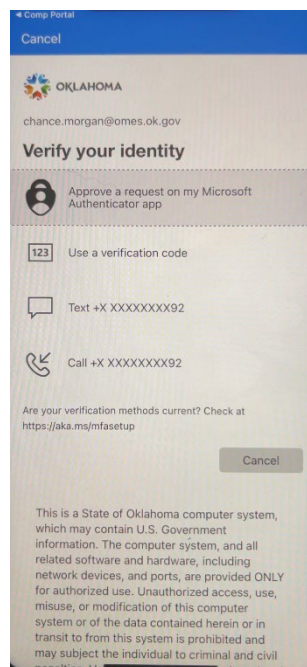

Authenticate the login.

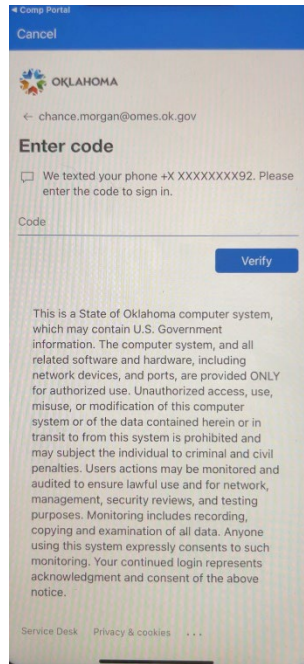

Verify.

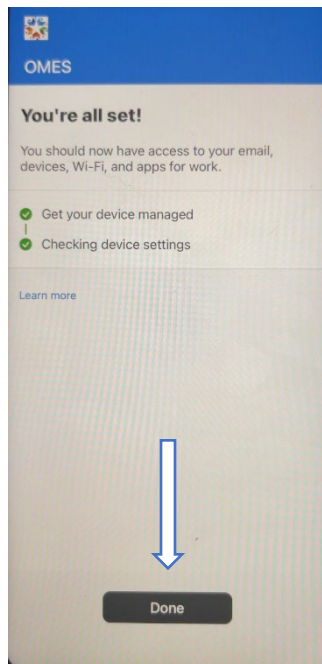

Select **Done.**

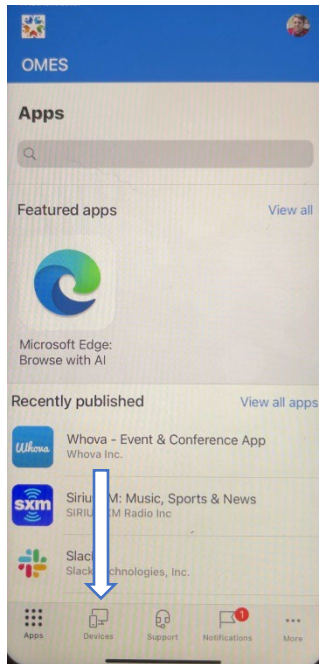

Select **Devices**.

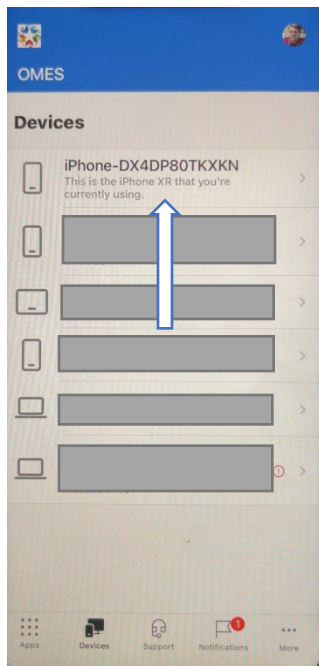

Select the device you are enrolling, and ensure it is compliant.

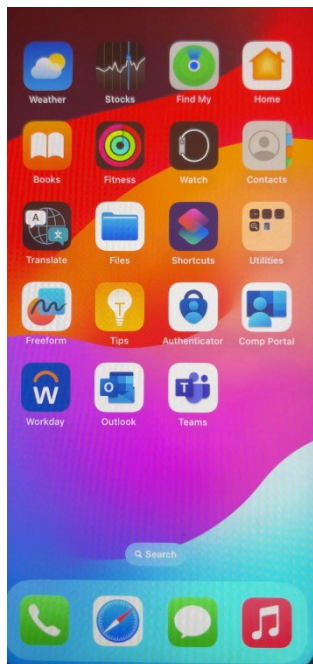

The device is now enrolled in Intune.